

EXTERNAL DIMENSION

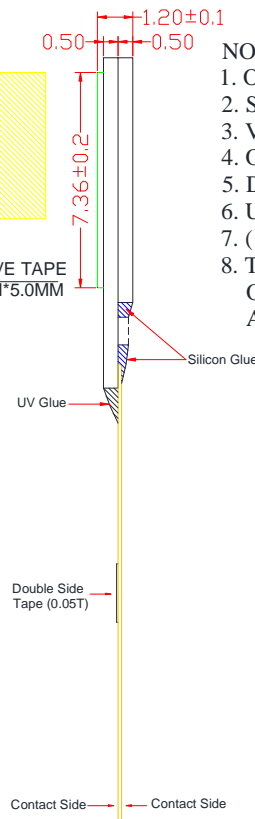

NOTES:

1. OPERATING TEMP: -20°C TO 70°C
2. STORAGE TEMP: -30°C TO 80°C
3. VIEWING DIRECTION: ALL
4. OLED DRIVE IC: SSD1309Z
5. DISPLAY COLOR: Blue / Green / Red / White / Yellow
6. UNSPECIFIED TOLERANCES: ±0.2mm.
7. () MEANS: DIMENSION FOR REFERENCE
8. THE PROTECTIVE FILMS ON FRONT SIDE OF OLED MUST BE REMOVED BEFORE ASSEMBLY BY CUSTOMER

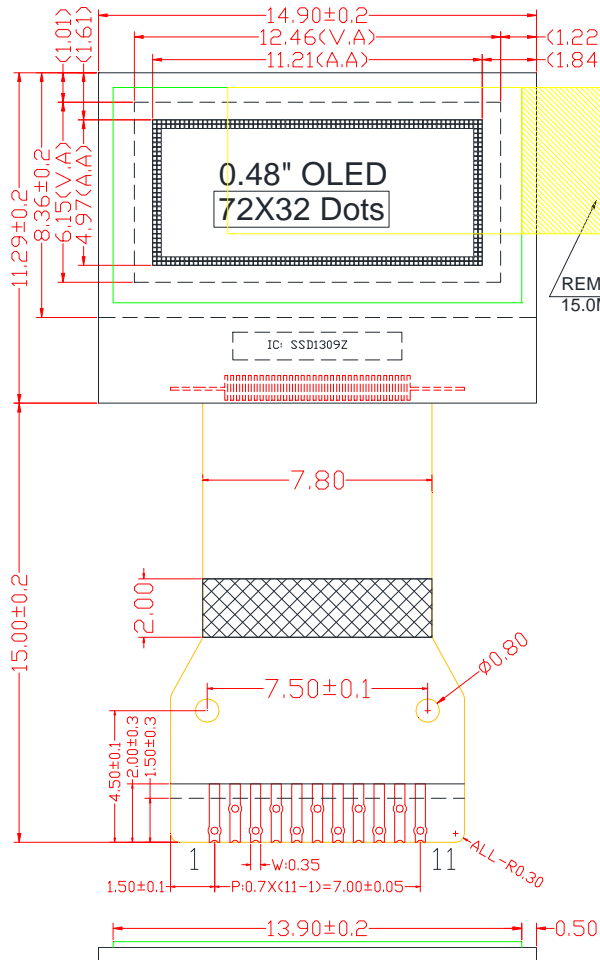
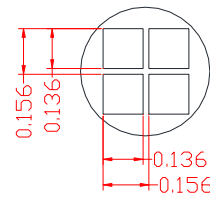

Dots detail
scale 10x

PIN CONNECTIONS

PIN NO	1	2	3	4	5	6
SYMBOL	VCC	VSS	CS#	RES#	D/C#	SCLK
PIN NO	7	8	9	10	11	
SYMBOL	SDIN	NC	VCOMH	NC	VDD	