

# PT0434880TC-B1 SERIES (480\*RGB\*800 DOTS)

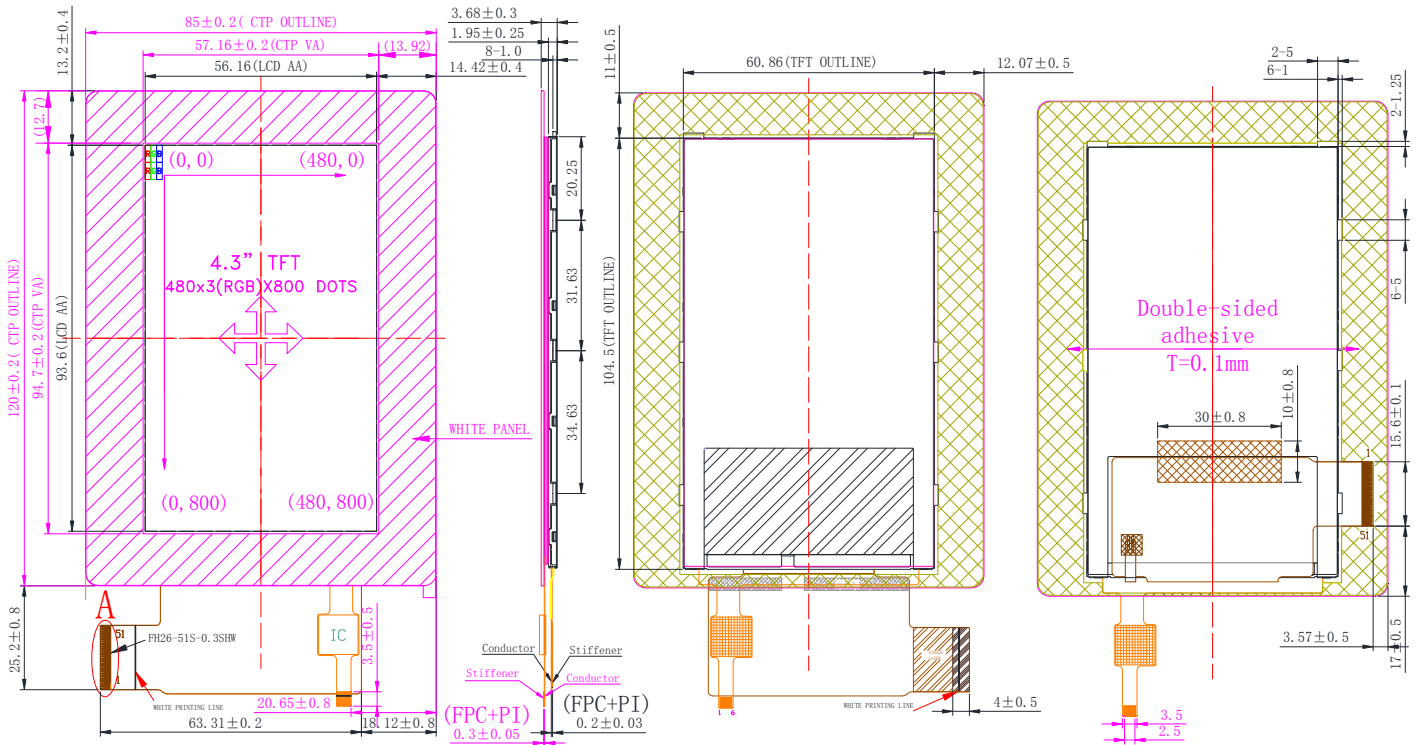

魔誼科技股份有限公司  
Palm Technology Co., Ltd.

## EXTERNAL DIMENSION



- NOTES:
1. DISPLAY TYPE: 4.3" TFT/IPS
  2. VIEWING DIRECTION: 80/80/80/270
  3. LCD DRIVE IC: ILI9806E
  4. POLARIZER MODE: TRANSMISSIVE/Negative
  5. OPERATING TEMP: -20° C~+70° C
  6. STORAGE TEMP: -30° C~+80° C
  7. UNMARKER TOLERANCE: ±0.20
  8. REQUIREMENTS ON ENVIRONMENTAL PROTECTION: RoHS
  9. THE COLOR OF THE COVER GLASS PRINTING IS TO THE COLOR SAMPLE PROVIDED BY PRICE AS CLOSE AS POSSIBLE.
  10. PRODUCTION TOOL WILL BE USED TO AVOID VISIBLE BACKLING BLEED.

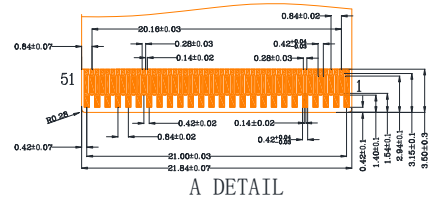

## PIN CONNECTIONS

### TFT LCD MODULE

PIN NO	1	2	3	4	5	6	7	8	9	10	11
SYMBOL	LEDK	LEDA	NC	NC	NC	NC	GND	VCI	NC	IOVCC	TE
PIN NO	12	13	14	15	16	17	18	19	20	21	22
SYMBOL	SDO	SDI	RS	/CS	/RESET	B7	B6	B5	B4	B3	B2
PIN NO	23	24	25	26	27	28	29	30	31	32	33
SYMBOL	B1	B0	G7	G6	G5	G4	G3	G2	G1	G0	R7
PIN NO	34	35	36	37	38	39	40	41	42	43	44
SYMBOL	R6	R5	R4	R3	R2	R1	R0	ENABLE	DOTCLK	HSYNC	VSYNC
PIN NO	45	46	47	48	49	50	51				
SYMBOL	NC	SCL	IM0	IM1	IM2	IM3	GND				

### CAPACITIVE TOUCH

PIN NO	1	2	3	4	5	6
SYMBOL	SDA	SCL	RST	INT	GND	VCC